

ŘEZ ŠACHTOU / SHAFT GROUNDPLAN
RÁM / FRAME: TLM16-SK
PRŮCHOZÍ / TWO ENTRANCES CABIN
M1:20

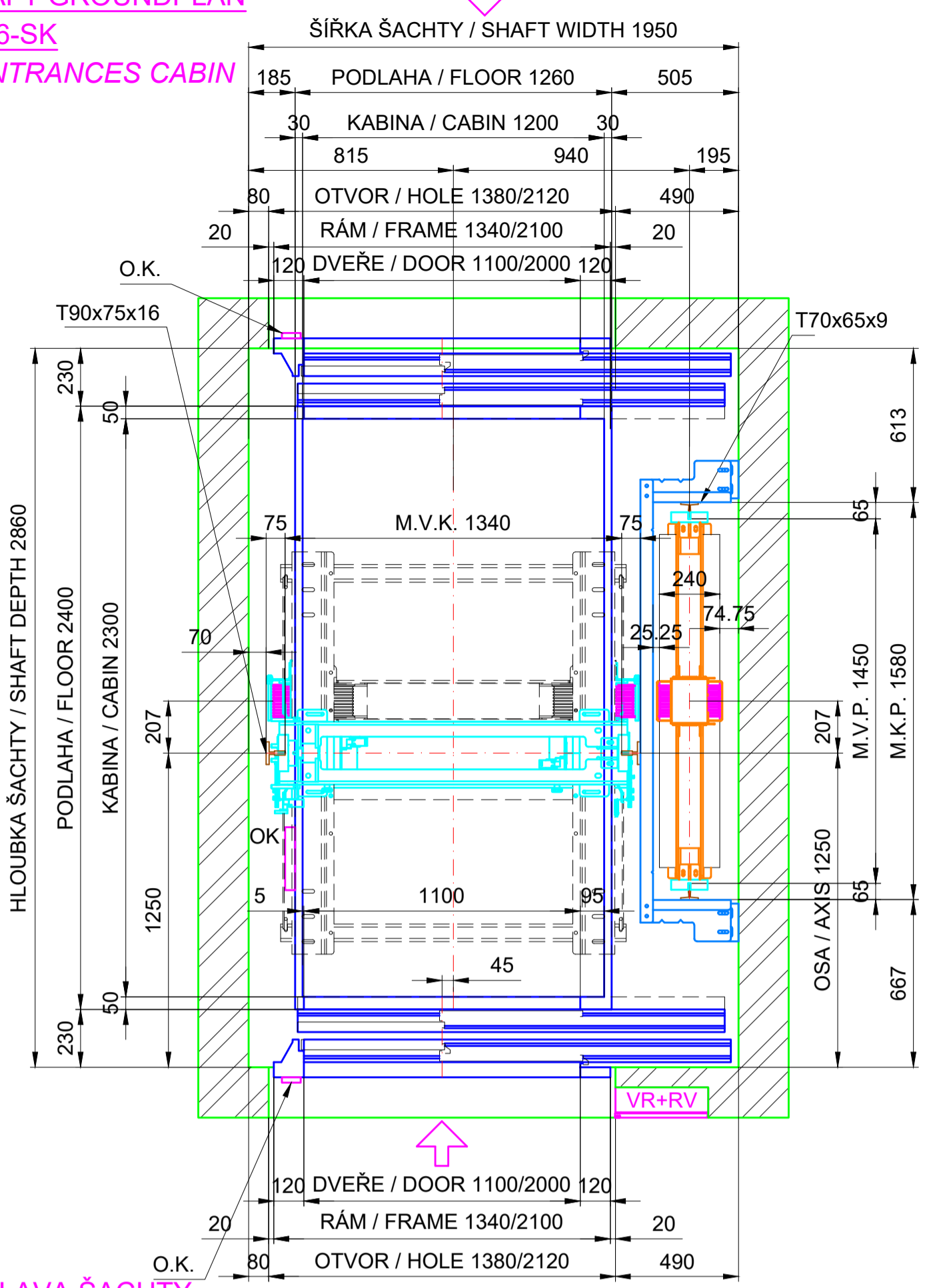

ŘEZ ŠACHTOU / SHAFT GROUNDPLAN
RÁM / FRAME: TLM16-SK
NEPRŮCHOZÍ / ONE ENTRANCES CABIN
M1:20

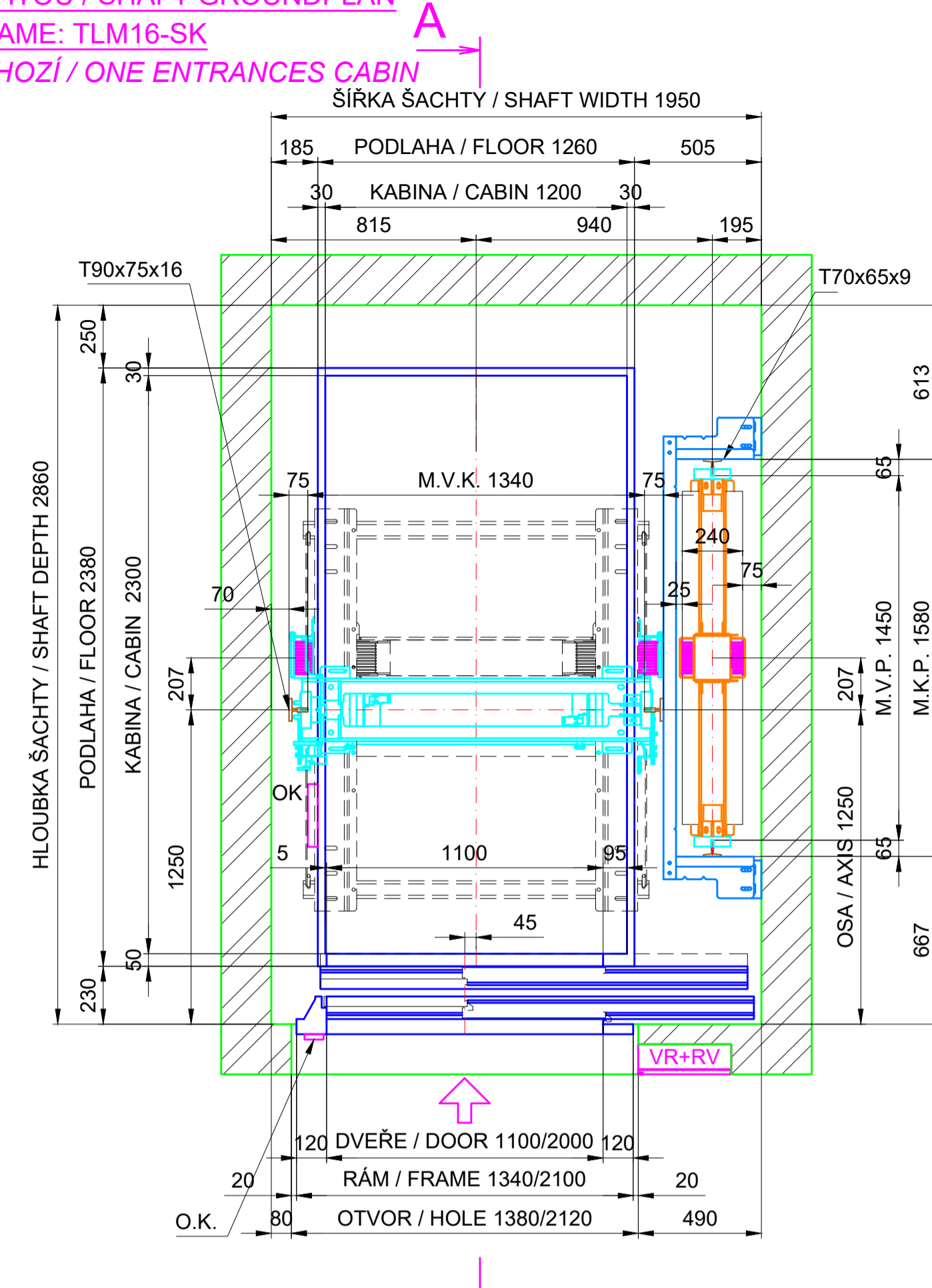

DVEŘNÍ OTVOR / DOOR HOLE
KLEFER 2P (MODEL 40/10 PM)
M1:20

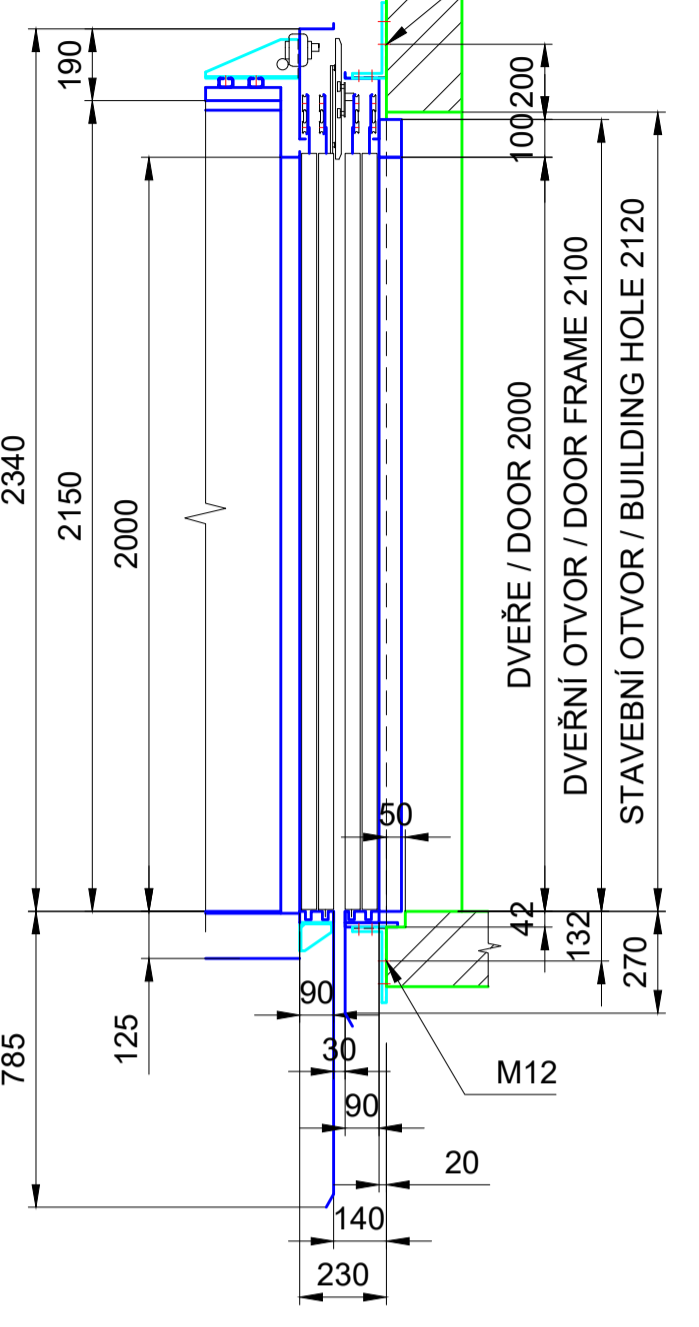

MONTÁŽNÍ OKO
EYE ASSEMBLY
MIN. NOSNOST / MIN. LOAD 1000kg

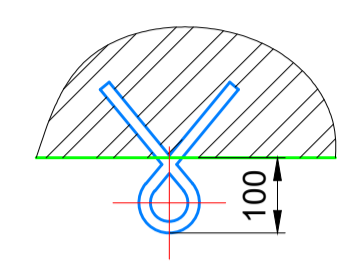

HLAVA ŠACHTY
SHAFT HEAD
M1:20

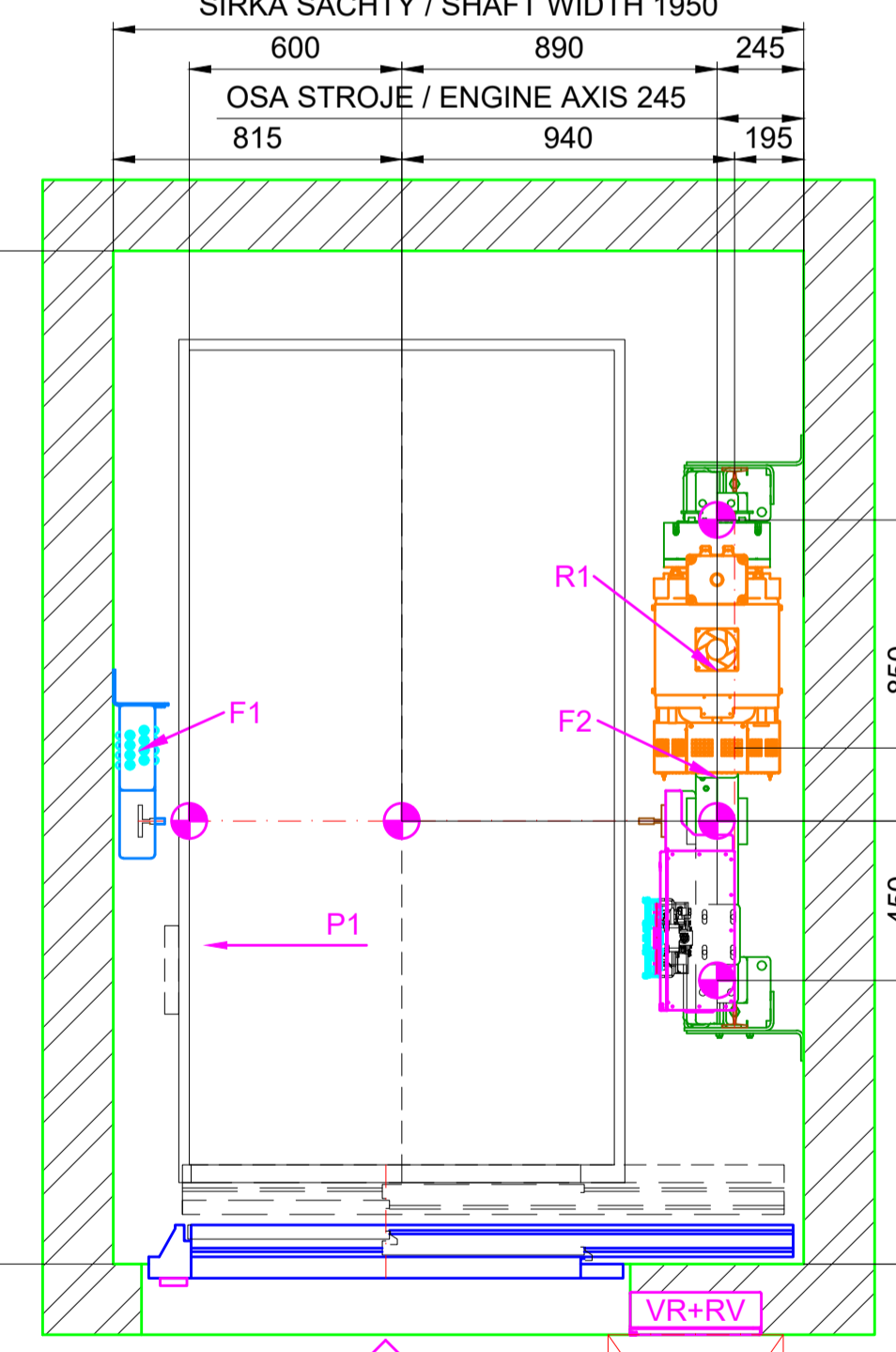

PROHLUBENÍ
PIT
M 1:20

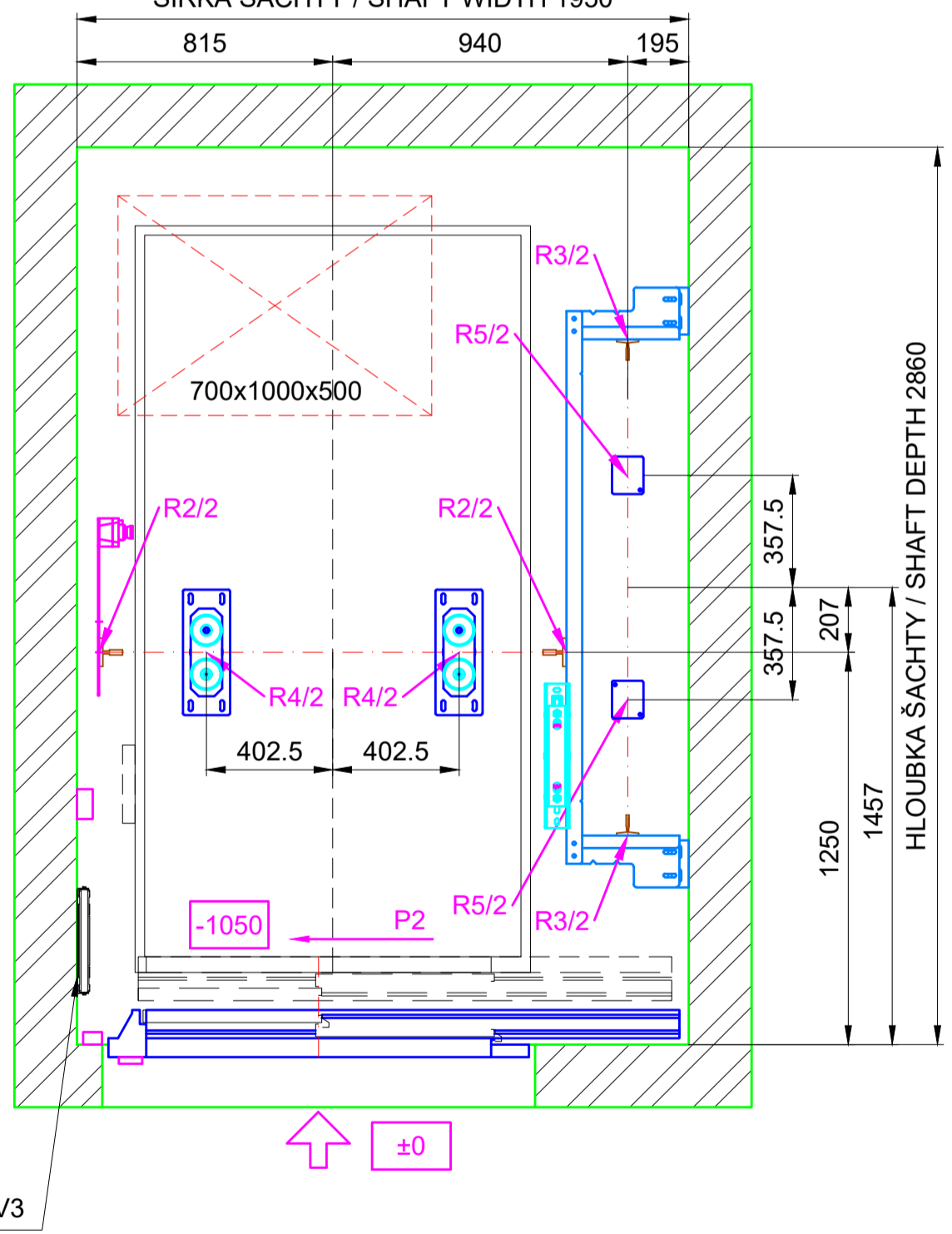

P2
(OBEČNĚ / GENERAL)
M 1:30

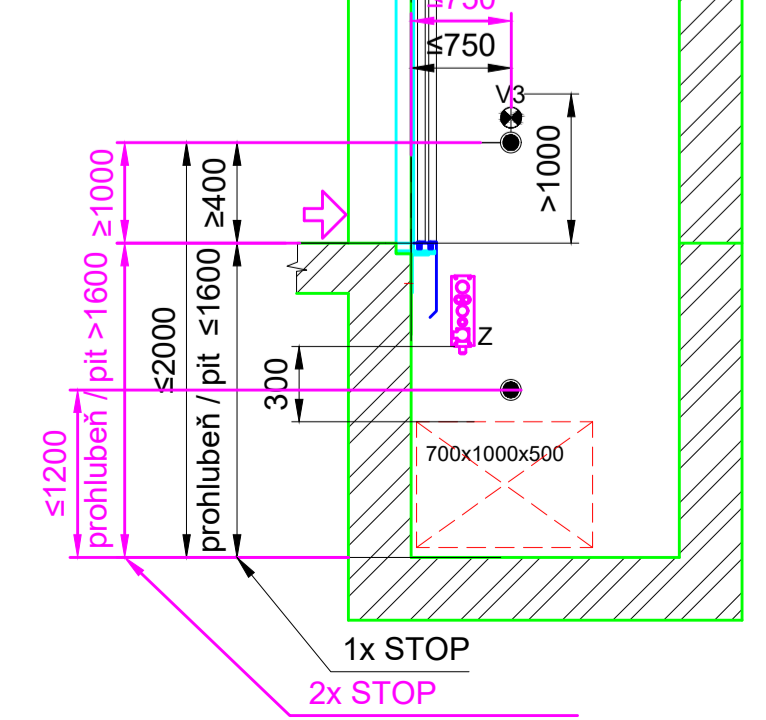

REQUIREMENTS:

PIT:
 In the pit there is a STOP switch, an electrical socket, a switch electrical lighting of the shaft and control combination for the inspection drive acc EN 81-20 ed.2, chap. 5.2.1.5

LIGHTING:
 Shafts - permanently mounted electric lighting providing lighting intensity min. 50 lx 1.0 m above the roof of the cabin in its vertical projection. At least 50lx 1.0m above the floor of the pit. In other places of the shaft at least 20 lx according to EN 81-20 ed.2, chap. 5.2.1.4.1

Platform - lighting intensity 50 lx on the floor near the shaft door

Space for machinery and pulleys - workplaces in machinery spaces and pulley rooms must be equipped with permanently installed electric lighting with an illumination intensity of at least 200lx at floor level wherever a person must work and 50lx at floor level for movement between work areas. The power supply of this lighting must comply with EN 81-20 ed.2, chapter 5.10.7.1.

SHAFT VENTILATION: according to EN 81-20 ed.2, chap. 5.2.1.3 and in appendix E.3 ENVIRONMENT: according to EN 81-20 ed.2 with basic temperature from +5 to +40°C The environment from the point of view of electric shock current according to 33 2000-5-51 ed.3 - normal

CABIN ROOF:
 On the roof of the cabin there is a controller for the revision drive, a STOP controller and an electric socket according to EN 81-20 ed.2, chap. 5.4.8. The roof must be equipped with a trench sheet with a height of 100 mm according to EN 81-20 ed.2, ch. 5.4.7.2

Railings on the cabin roof according to EN 81-20 ed.2, chap. 5.4.7.4 with a height of 700 mm

TOLERANCE:

- M.V.K. and M.V.P. has a maximum deviation of 0 to +2 mm
 - The axis of the cabin guide rails has a maximum deviation of -5 to +5 mm
 - The front wall of the shaft must be straight, max. deviation from the vertical -10 to +10 mm
 - The remaining walls have a maximum deviation from the vertical -20 to +20 mm
 - The consoles for anchoring the guide rails are made with a regulation of +20 mm to +20 mm

NOTE FORCES R2,R3,R4,R5, ACTS INDEPENDENTLY AT THE BOTTOM OF THE PIT THESE FORCE EFFECTS NEVER OCCUR AT THE SAME TIME

FORCES ACTING AT THE BUILDING STRUCTURE [N]

FORCE AT MACHINE ROOM FLOOR / FORCE ON GRATE TRANSMITTED TO BUILDING	R1 = 46 500 N
FORCE ACTING AT THE GUIDE RAILS IN THE X-AXIS DIRECTION - SAFETY G./NOR. OPERATION	Fx = 2050 N / 250 N
FORCE ACTING AT THE GUIDE RAILS IN THE Y-AXIS DIRECTION - SAFETY G./NOR. OPERATION	Fy = 1300 N / 780 N
FORCE UNDER CABIN GUIDE RAILS BOTTOM OF THE PIT WHEN EQUIPPED WITH SAFETY GEAR	R2 = 41 000 N
FORCE AT THE BOTTOM OF THE SHAFT FROM THE COUNTERWEIGHT GUIDE RAILS	R3 = 8300 N
FORCE UNDER BUFFERS OF THE CABIN WHEN THE CABIN LANDES AT THE BUFFERS	R4 = 98 700 N
FORCE AT THE BOTTOM OF THE SHAFT FROM THE COUNTERWEIGHT BUFFERS	R5 = 70 700 N
FORCE ACTING AT POSITION OF CABIN HINGE	F1 = 18800 N
FORCE ACTING AT POSITION OF COUNTERWEIGHT HINGE	F2 = 13300 N

FORCES

WEIGHT CAPACITY OF THE LIFT	Q= 12750 N	GRID	3PEN
FORCE OF CABIN	Ca= 6500 N	NOMINAL VOLTAGE	400 V +/-10%
FORCE OF FRAME	A= 4500 N	LIGHTING POWER SUPPLY	230V
FORCE OF OPERATOR	O= 965 N	PRIMARY FREQUENCY	50 Hz +/- 5%
FORCE OF ROPE	G= 1200 N	NOMINAL VOLTAGE OF DEVICE	13 A
		SHOT VOLTAGE OF DEVICE	18 A
		SECURITY OF INTAKE	C16 A

TYPE OF LIFT	CAPACITY (kg)	NUMBER OF PERSONS	SPEED (m/s)	TRAVEL (m)	NUMBER OF RIDES/HOUR	MACHINE POWER (kW)
LCmaxi 1275	1275	17	1.0	25	180	CEGI-ACT240, 9,2 kW

LEGENDA:

V3 - VYPÍNAČ OSVĚTLENÍ ŠACHTY / LIGHTING SWITCH OF SHAFT
 Z - ZASUVKA / PLUG
 I - PŘÍVOD 230V S JISTIČEM / SUPPLY 230V WITH CIRCUIT BRAKER
 R - ŽEBŘÍK / LADDER
 ● - OSVĚTLENÍ / LIGHTING
 ● - STOP
 O.K. - OVLADAČOVÁ KOMBINACE / THE CAR OPERATING PANEL
 VR - VÝTĚHOVÝ ROZVADĚČ / CONTROLLER OF ELEVATOR
 RV - ROZVODNICE S HL. VYPÍNAČEM / LIGHTING PANEL WITH MAIN SWITCH
 V1 - HL. VYPÍNAČ VÝTĚHU / MAIN SWITCH OF ELEVATOR
 V2 - VYPÍNAČ OSVĚTLENÍ STROJOVNY / LIGHTING SWITCH OF MACHINE ROOM
 ■ - PŮVODNÍ OTVORY / ORIGINAL HOLE
 ■ - NOVÉ OTVORY / NEW HOLE
 M.V.K. - MEZI VODÍTKY KLECE / BETWEEN GUIDE RAILS OF CABIN
 M.V.P. - MEZI VODÍTKY PROT. / BETWEEN GUIDE RAILS OF COUNTERWEIGHT
 M.K.P. - MEZI KONZOLY PROT. / BETWEEN GUIDE RAILS OF COUNTERWEIGHT CONSOLE